

Setting-out point	Easting	Northing
SOP 1	576055.905	110585.946
SOP 2	576058.698	110576.539

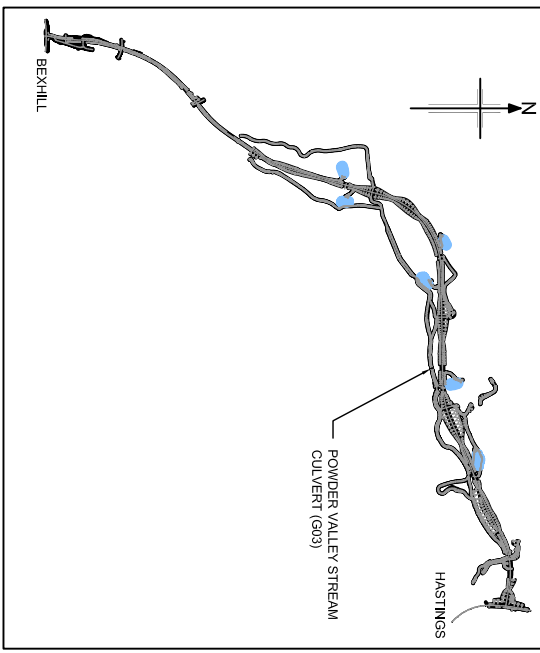

SAFETY, HEALTH AND ENVIRONMENTAL INFORMATION	
CONSTRUCTION	- None
MAINTENANCE / CLEANING	- None
DECOMMISSIONING / DEMOLITION	- None

- Notes**
- All dimensions are in millimetres unless noted otherwise.
 - All levels in metres above Ordnance Datum - Newlyn.
 - All exposed surfaces to have 25x25 chamfers unless noted otherwise.
 - Dimensions are not to be scaled from this drawing.
 - Backfill to be Class 6T lightweight expanded clay aggregate fill.
 - Concrete classes shall be as follows:
 - Mk ST4
 - C40/50
 - C40/50
 - Headwalls
 - Concrete finishes denoted thus:
 - Formed
 - Untorned
 - Formed surfaces of the box content by waterproofing system to be treated to achieve equivalent surface to U4 as described in the specification clause 1708.
 - Concrete protection to be as follows:
 - A - Spray applied waterproofing in accordance with Q12003 of the Specification
 - B - Waterproofing of all buried concrete surfaces in accordance with C12004 of the Specification
 - All external buried precast concrete box faces (including the underside of base slab), not receiving Type A spray-applied waterproofing shall be painted with 2 coats of Type B bituminous waterproofing. All buried precast concrete surfaces accessible after bedding shall be painted with 2 coats of bituminous waterproofing. The face of bituminous coat shall be in accordance with C12004 of the Specification.
 - All works to be carried out in accordance with the Specification for Highway Works / Technical Specifications for the project.
 - Both walls to be backfilled simultaneously with a level difference not exceeding 0.5m.
 - Sealing of the channel is to be Mk. B as detailed on drawing B1297000-PH2/3000.01A/0037
 - Precast culvert box units by Macrete Ireland Ltd. Refer to Macrete drawings, C316/RC4 Rev-A, C316/RCS Rev-A & C316/RCS Rev-A for box reinforcement details.
 - Culvert foundation is to be pre-centred as shown on precamber detail to allow for settlement over time.
 - Light sealant material to be bitumen impregnated open cell flexible polyurethanes from sealant slip suitable for nominal 50mm joint gap at 80% compression.

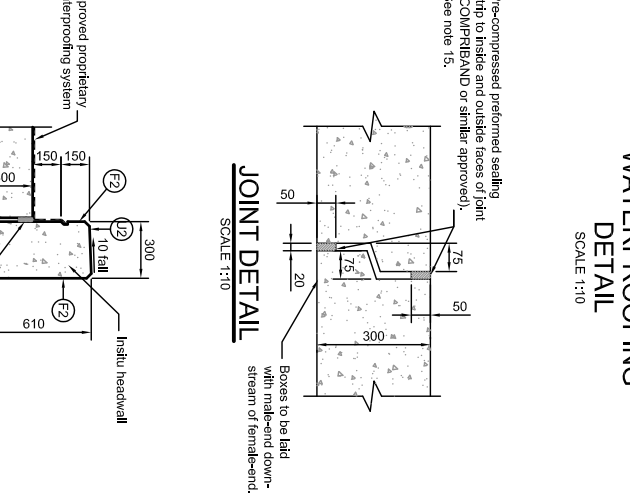
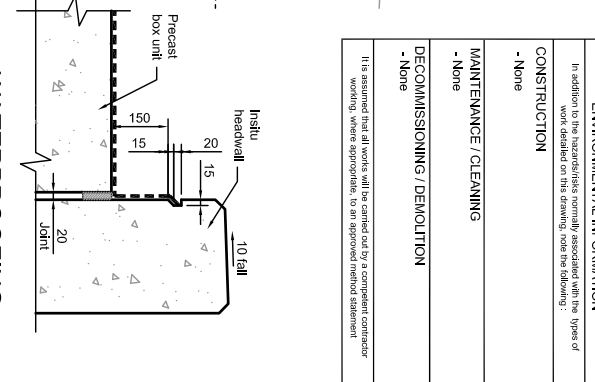
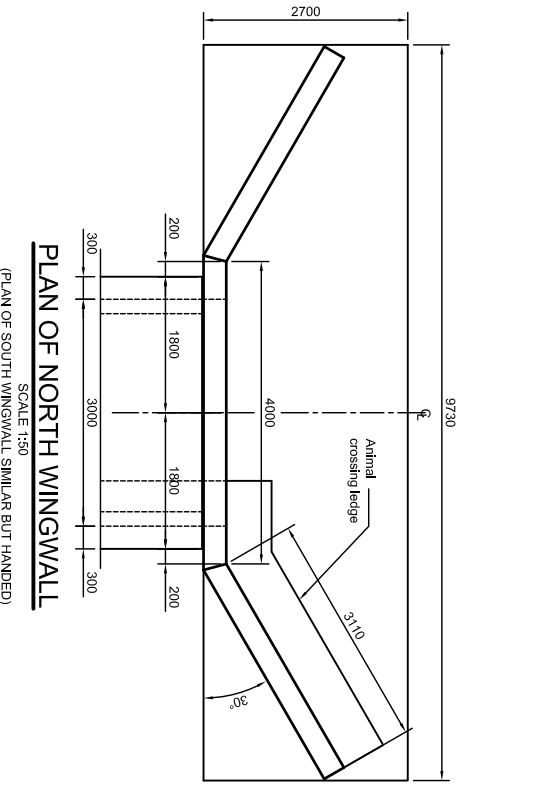
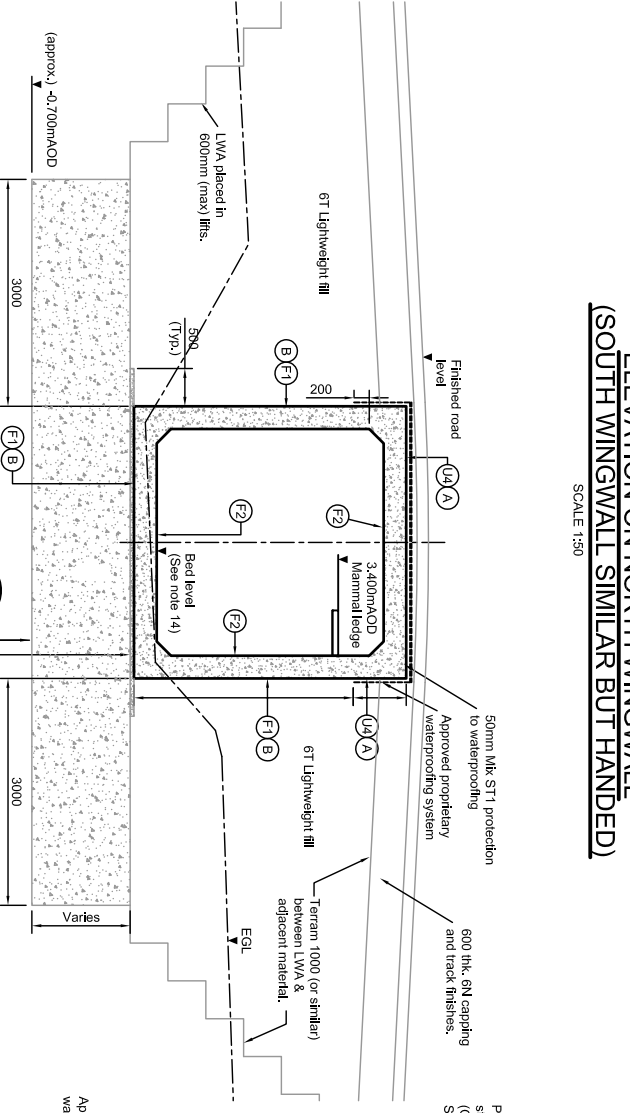
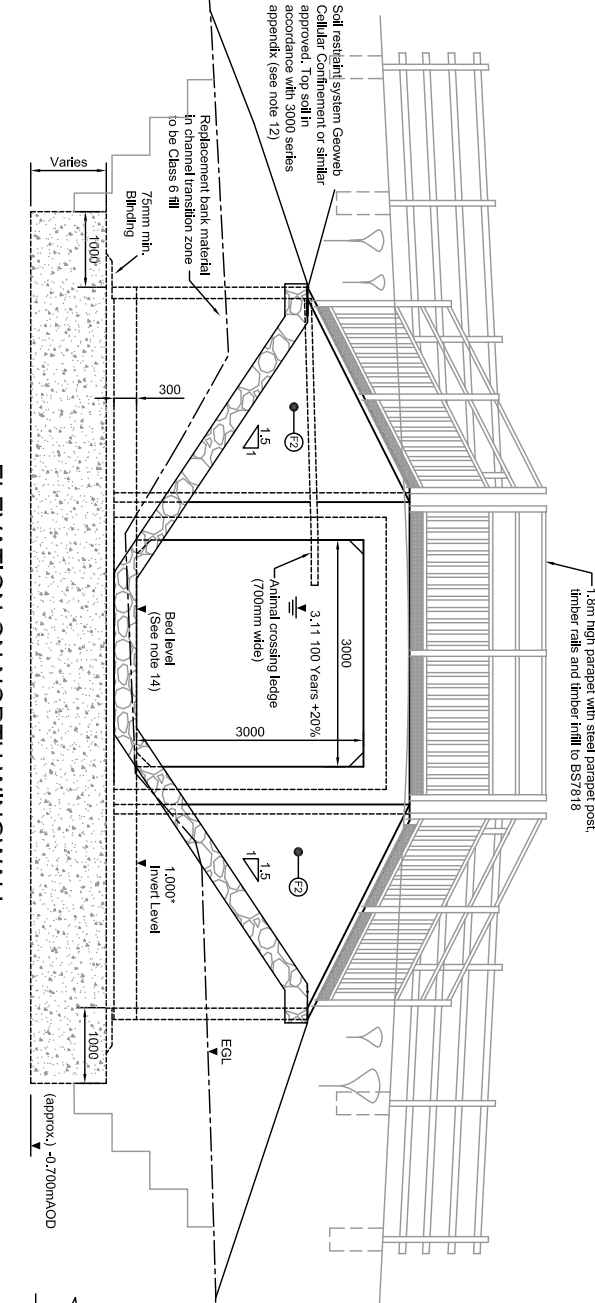
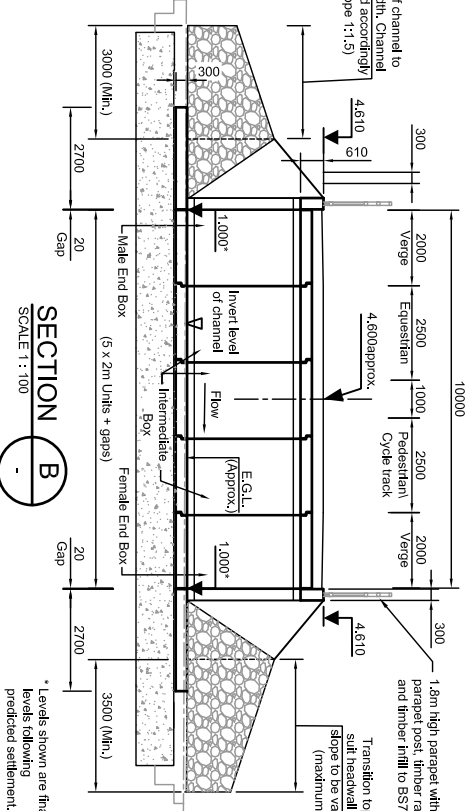
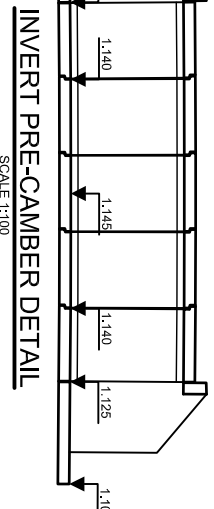
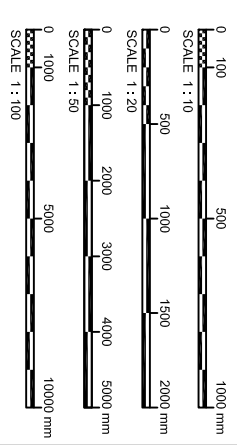

Reproduction from the Ordnance Survey Map with the permission of the controller of Her Majesty's stationery office Crown copyright reserved Licence No. 10001.9601.2008

Rev	Rev. Date	Purpose of revision	Drawn	Checked	Rev'd	Approved
C1	27/07/2014	APPROVAL IN PRINCIPLE	GN	RB	RB	JP
R2	21/07/2015	CULVERT LENGTH REDUCED	GN	RB	RB	JP
C2	03/08/2014	FOR CONSTRUCTION	GN	RB	RB	JP
R1	25/02/2014	FOR REVIEW	GN	TL	RB	HD
R0	04/03/2013	FOR REVIEW	GN	TL	RB	HD

JACOBS
Simpson House, 6 Cherry Orchard Road, London, Surrey, CR9 6BE
Tel: +44(0)2038 668 8212 Fax: +44(0)2038 661 2499
www.jacobs.com

HOCHTIEF
WATER & POWER

Client: **HOCHTIEF WATER & POWER**

Project: **BEXHILL TO HASTINGS LINK ROAD**

Drawing title: **POWDERMILL VALLEY STREAM UNDERBRIDGE (G03) GENERAL ARRANGEMENT**

Drawing status: **APPROVAL IN PRINCIPLE**

Scale: **SCALE @ A1 DO NOT SCALE**

Issued No: **B1297000**

Client No:

Drawing number: **B1297000-PH2/1600.01A/1907**

Rev: **C1**

This drawing is not to be used in whole or part other than for the intended purpose and project as defined on the drawing. Refer to the contract for full terms and conditions.